



Callubri
STATION

2023 / 2024 Wedding, Corporate & Private Event Packages

Callubri Station is one of the most unique venues in the region, fusing history and modern sophistication to create an unparalleled experience. Steeped in 145 years of family history, the 11500-hectare property provides the perfect secluded outback location for your special event.

With uninterrupted views across the plains, The Shearer's Quarters at Callubri Station offers a magnificent dining space seating up to 110 guests or enjoy an alfresco evening under the stars using one of our outdoor dining spaces!

Welcome to Our Station!

Nestled between the remote country towns of Nyngan and Tottenham in Central West NSW, Callubri Station offers a truly unique premium farm stay and event space.

The Shearer's Quarters Hall, a former Officer's Mess brought to the property after World War II, accommodates up to 110 guests with a chesterfield lounge and fully licensed bar, pianola and gramophone, church doors, vintage bentwood chairs, rustic timber tables and exposed beams adorned with old brass chandeliers. With access to your own outdoor covered lounge deck and 12mx12m dance floor under the stars, we can provide everything you need to style the ultimate event, large or small.

Callubri Station offers inclusive packages for an array of corporate, wedding, school and private celebrations. Our Shearer's Quarters Hall is perfect for any style of event with seating layouts available to suit conferences, meetings and gala dinners or why not keep things social with a more casual roaming cocktail style service.

With more than 12 years in the catering industry, you will be treated to hand-made dishes with a dedication to showcasing the best produce from our farm, our friends, and Central West NSW.

Experience the joys of a journey off the beaten track and join us for your next special event.



Station Events

Features and Inclusions

- Exclusive, private use of your choice of our gorgeous event spaces;
 - The Shearer's Quarters Hall (110 Seated, 200 cocktail)
 - The Shearer's Quarters Outdoor Bar and Dance Deck (open air, 60 seated, 120 cocktail)
 - The Shearer's Quarters Lounge Deck (covered, 24 seated, 30 cocktail)
 - The Woolshed (200 cocktail)
- Exclusive use and privacy with every booking
- Personalised event coordination and support to assist with the planning of your event
- Access for set-up/pack-up on days either side of you event on request (subject to availability)
- Access to fabulous local industry contacts eg. floristry, styling, entertainment, transport companies
- A rustic easel for your welcome board/seating plan at the entrance along with a gift/cake table
- Air conditioned/heated indoor space with acoustically designed sound boards and furnishings
- Bentwood chairs, timber tables, vintage chandeliers and exposed beams for hanging installations
- Room set with premium glassware, satin finish cutlery, white crockery and printed table menus
- Top of the range sound system for live music or connection to iPod including 2 microphones
- Co-ordination with local transport companies and dedicated parking within the grounds.

Extras

Do you need some addons to make your event just perfect? The following can be hired as extras:

- Pure linen white tablecloths and napkins
- Data projector and screen, stationary, lectern, flip charts or white board and markers
- Eight restored church pews for seating up to 72 people for outdoor ceremonies and events
- Our Cook's Hut can be booked as a private bridal room or nursing space.





Breakfast Packages

Enjoy an early morning breakfast meeting in our Shearer's Quarters event space. Our breakfast packages include a three-hour service. (Please note a minimum 30 guests midweek and 50 guests on weekends. Please request a quote for smaller groups)

All our packages include our boutique Tea and Coffee station featuring French Press and self-serve Espresso coffee by Bills Beans, a selection of local Tea Queen Teas and herbal infusions, iced water and juice.

The Stationhand's Fare \$25pp

Continental breakfast including Callubri Station oat muesli, granola or bircher, Greek yoghurt, stewed fruits, house sour dough toast with butter and boutique spreads

The Stockman's Tucker \$37pp

Continental breakfast as above plus one selection from:

- Smoothie bowl
- Breakfast grain salad with poached egg
- Free range egg and maple bacon rolls
- Ham, cheese and bechamel croissants

The Overseer's Spread \$45pp

Continental breakfast as above plus one selection from:

- Savoury corn fritters with crispy bacon and guacamole
- Poached, fried or cheesy scrambled eggs, toasted sourdough, mushrooms, bacon and tomatoes
- Smashed avocado on house sour dough with crumbled fetta, lemon squeeze and cured salmon
- Brioche French toast with berry sauce and Greek yoghurt

Extras

- Fresh fruit table platters (\$6pp)
- Barista hire (half day \$8pp/ full day \$12pp).

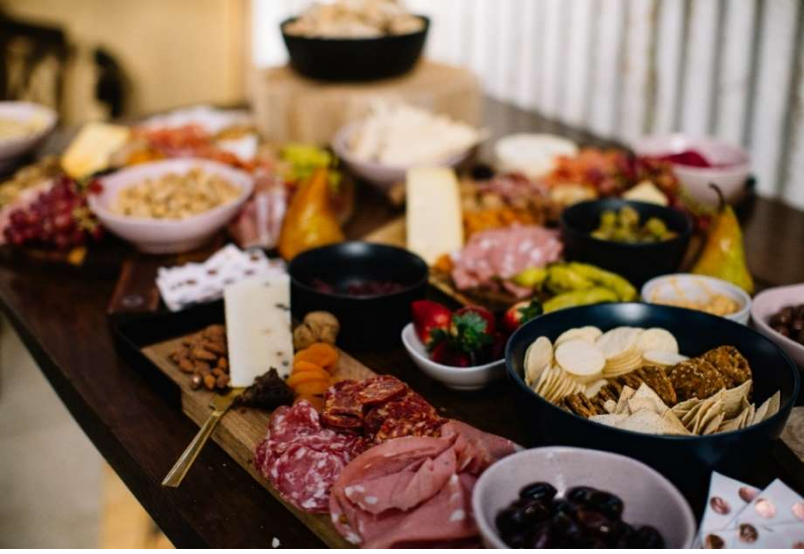

All Day Meeting Packages

Get the energy flowing for your next work conference or business meeting in our Shearer's Quarters event space. Both our half-day and full-day packages include our boutique Tea and Coffee station featuring French Press and self-serve Espresso coffee by Bills Beans, a selection of local Tea Queen Teas and herbal infusions, iced water and juice. (Please note a minimum 30 guests midweek and 50 guests on weekends. Please request a quote for smaller groups)

Half Day Package \$49pp

- Morning tea and lunch OR
- Lunch and afternoon tea
- 5-hour package

Morning/Afternoon Tea Menu (select 2)

- Chocolate and walnut brownie
- Berry yoghurt muffins
- House made scones with jam and cream
- Orange and poppyseed slice
- Anzac slice (GF)
- Custom iced cookies (GF/VEGAN available)
- Cheddar cheese scones with roast beef
- Mini house made sausage rolls with relish
- Corn and haloumi fritters with guacamole
- Selection of mini savoury quiches

Full Day Package \$75pp

- Morning tea, lunch and afternoon tea
- 8-hour package

Lunch Menu (select 1)

- Platters of baby baguettes and mini wraps with a selection of fillings including ham, cheese and chutney, chicken waldorf, char grilled veg and fetta, salami and swiss cheese or roast beef, mustard and greens.
- Individual 'grains and greens' salad bowls with fetta and grilled chicken
- Ploughman's lunch grazing table of gourmet salads, cold meats, dips, chutneys, cheese and rolls with butter (+\$5pp)



Cocktail Dining @ The Shearer's Quarters

Are you looking for a relaxed and laid-back way to mingle and dine? Let's throw a cocktail party!

As a little add on to a hard day's work or a stand-alone event, cocktail events are a fabulous way to celebrate! Here are a few options...

(Please note a minimum 30 guests midweek (Mon – Thurs) and 50 guests on weekends. Please request a quote for smaller groups)

A little post work fling \$39pp (Available as add on to day packages only)

- A selection of two standard canapes
- Roving grazing boards
- Two-hours service

Add a two-hour beverage package from \$39pp

Something more \$59pp (Available as add on to day packages only)

- A selection of four standard canapes
- One roving mini meal
- Three-hours service

Add a three-hour beverage package from \$49pp

The full catastrophe \$79pp (Available as add on or standalone package)

- A selection of six standard canapes
- One roving mini meal
- Four-hours service

Add a four-hour beverage package from \$59pp

Dining Packages @ The Shearer's Quarters

Four Hour Luncheon Package

Our luncheon package commences at 12 midday and includes a four-hour service. (Please note a minimum 50 guests. Please request a quote for smaller groups)

Our luncheon packages start at \$75 per person and includes three courses:

- Grazing boards served roving as your guests mingle
- Our house baked bread and local olive oil or butter served to all tables
- Two main dishes with sides served either plated or on shared table platters
- Your event cake served on platters with a tea and coffee station is included complimentary
- Dessert may be added for \$4pp for your event cake plated with cream and berries, \$10pp for a selection of two petit fours or \$12-\$16pp for plated desserts
- Drinks packages are available as all-inclusive and include all bar staff, premium French glassware, local and Australian beverages.



Five Hour Dinner Package

Our dinner packages commence at 6.30pm and include a five-hour service. (Please note a minimum 50 guests. Please request a quote for smaller groups)

Our dinner packages start at \$89 per person and includes four courses:

- Grazing boards served roving as your guests mingle
- Two canapés served roving, or two alternate entrees served plated, or on shared table platters
- Our house baked bread and local olive oil or butter served to all tables
- Two main dishes with sides served either plated or on shared table platters
- Your event cake served on platters with a tea and coffee station is included complimentary
- Dessert may be added for \$4pp for your event cake plated with cream and berries, \$10pp for a selection of two petit fours or \$12-\$16pp for plated desserts
- Drinks packages are available as all-inclusive and include all bar staff, premium French glassware, local and Australian beverages.



Menus @ The Shearer's Quarters

Canapes

Additional selections can be added to a menu for \$5pp (Standard) and \$7pp (Premium).
To upgrade canapes in our packages to premium please add \$2 per person per upgrade.

Standard

- Thai Chicken Sesame Puffs, Nam Jim
- Blue Cheese, Pear & Walnut Tarts (v)
- Corn & Haloumi Fritter, Smashed Avo (v)
- Polenta, Olive Tapenade & Persian Fetta (v)
- Moroccan Beef Kofta, Minted Yoghurt (gf)
- Cherry Tomato, Basil Jelly, whipped Ricotta (v/gf)
- Haloumi Cigars, Capsicum Jam (v)
- Goats Cheese & Caramelised Onion Tart (v)
- Mini Pumpkin, Rosemary & Fetta Quiche (v)
- Greek Spanakopita Pie, Spiced Yoghurt (v)
- Chicken Liver Parfait, Onion Jam on Brioche
- French Onion Demi Tasse, Garlic Crouton (v)
- Pork Pot Stickers, Chilli Sauce
- Chorizo & Goats Cheese Mini Quiche
- Semi Dried Tomato & Herb Arancini (v)
- Rare Beef & Horseradish Baby Scone
- Satay Chicken Skewers (gf)
- Southern Fried Buttermilk Chicken (gf)
- Smoked Beef & Chilli Jam, Corn Bread
- Tempura Fish Bites, Lemon Myrtle Aioli

Premium

- St Jacques Scallops, pickled Celeriac (gf)
- Duck Spring Rolls, Plum Sauce
- Beef & Black Olive Empanadas, Guacamole
- Australian King Ocean Prawns, Myrtle Aioli (gf)
- Mandarin & Mint Duck Rice Paper Rolls (gf)
- Beef Cheek Pies, Onion Jam
- Moroccan Lamb Filo Parcels, Minted Yoghurt
- Crispy Pork Belly Bites, Spiced Apple
- Beetroot & Vodka cured Salmon Blini
- Polenta, Duck Confit & Caramelised Onion
- Natural Oysters, Virgin Mary Shots (gf)
- Added extra: Vodka Dropper Bottles (+\$3pp)
- Kangaroo Fillet, Beetroot Kasundi & Goat's Curd
- Kingfish & Miso Ceviche Spoons
- Chilli Con Carne, Sour Cream & Nacho Crumb



Entree

Entrée may be added to our packages for \$12pp (Standard) and \$16pp (Premium).

Standard

- Herb Risotto, Milk Poached Chicken, Basil (gf)
- Micro Green & Pear Salad, Aged Parmesan, Candied Walnut, Balsamic (v,gf)
- Pumpkin & Pine Nut Arancini, Napoli, Aioli (v)
- Vietnamese Chicken Salad (gf)
- Moroccan Lamb Pie, Sweet Potato Puree
- Truffled Potato & Leek Soup, Garlic Crouton (v)
- Fetta, Red Pepper & Leek Tart (v)
- Beef Cheek & Red Wine Pie, House Relish
- Farmhouse Terrine, shaved Fennel Salad (gf)
- Lamb Neck & Chickpea Soup (gf)
- Caprese Salad, pulled Burrata (v,gf)
- Carbonara Orecchiette Pasta , crispy Pancetta
- Minestrone Soup , Risoni & shaved Parmesan (gf)

Premium

- Beetroot & Vodka cured Salmon Gravadlax, Orange & Fennel Salad
- Crispy Skin Duck Breast, Cranberry Masala (gf)
- King Prawns, Pecorino Risotto (gf)
- Smoked Kangaroo, Beetroot, Mountain Pepper
- Lamb Rump, Buckwheat, Salsa Verde (gf)
- Spiced Beef, Cucumber, Bean Shoots (gf)
- Saffron Risotto, House Smoked Salmon (gf)
- Seared Scallop, Celeriac Puree, Broad Bean & Crispy Pancetta (gf)
- Soft Polenta, Orange Scented Duck Confit & Caramelised Onion (gf)
- Smoked Beef Brisket, Corn Grits, Bourbon Mop



Mains

A selection of two mains and two sides is included in our packages. Please add \$6pp to upgrade to premium dishes.

Standard

- Chicken Chasseur, Potato puree
- Beef Bourguignon, Potato scallop
- Pulled Roast Lamb, Baked Butternut
- Portuguese Chicken, Spiced Cous Cous
- Apricot Chicken, Rice Pilaf, Almonds
- Lamb & Quince Tagine, Spiced Cous Cous
- Salsa Verde Chicken Breast, Risoni
- Red Wine Braised Beef Cheek, Polenta
- Cajun Chicken, Grilled Veg, Yoghurt
- Prosciutto wrapped Chicken, Smashed Peas, Mint, Ricotta

Premium

- Beef Fillet, Potato, Horseradish & Chive Mash, Sweet Onion & Red Wine Jus
- Lamb Rump, Lemon Scented Potatoes, Black Olives, Tomatoes & Herb Jus
- Oven Baked Market Fish, Celeriac Puree, Poached Fennel
- Cinnamon Duck Breast, Orange & Sweet Potato Puree, Cherry Sauce
- Crispy Pork Belly, Apple & Fennel
- Confit Salmon, Citrus Butter, Celeriac
- Five Spice Lamb Shanks, Barley & Veg



Sides

- Seasonal Greens, Butter & Lemon
- Oven Roasted Chats, Truffle Oil & Herbs
- Leafy Greens, Honey Mustard Dressing
- Root Veggies in Honey & Butter

Desserts- Plated

Dessert can be added to our packages for \$12pp (Standard) and \$16pp (Premium).

Standard

- White Chocolate Baby Cake, Berry Coulis
- Poached Pear, Chocolate Ganache Tart
- Vanilla Bean Panna Cotta, stewed Plum
- Summer Citrus Trifle
- Sticky Date Pudding, Double Cream
- Lemon Curd Mini Tart, Citrus Mint Salad

Premium

- Choc Espresso Flourless Cake, Sour Cherry
- Honey & Milk Chocolate Mousse, Pear
- Crème Brulee, Port Stewed Fig Compote
- Eton Mess Martini, Seasonal Berries
- Caramel & Wattle Seed Tart, Double Cream
- Tiramisu, Citrus, Bitter Chocolate & Berry
- Citrus Curd, Torched Meringue, Tart Crumb
- Apple & Rhubarb, Crumble, Crème Anglaise
- Selection of local Cheeses, Crackers, Quince

Desserts- Petit Fours

Petit fours can be added to our packages for \$5pp (Standard) and \$7pp (Premium).

Standard

- Dark Choc & Walnut Brownie Squares
- Orange & Poppy Seed Friands
- White Choc & Raspberry Mini Cakes
- Three Seed Anzac Bites (gf)
- Mixed Berry & Almond Friands

Premium

- Chocolate Mousse Shots, Candied Orange
- Trio of Gelato, Waffle Cones
- Baked NY Mini Cheesecakes
- Espresso Baklava, Pistachios
- Citrus Curd Shots, Pastry Chard
- Chocolate Espresso Flourless Mini Cakes (gf)
- Orange & Chocolate Tiramisu Shot



Imbibing @ Callubri Station

To complement your chosen luncheon or dinner, our all-inclusive beverage packages range from our Station Selection to the Cocky's Choice and Homestead Cellar for something special. All packages include bar staff, premium French glassware, a range of premium fruit juices, soft drinks and sparkling water.

As a special touch of class you may wish to offer guests a hand-crafted cocktail to enjoy whilst mingling. An extensive list of cocktails is available as an add on to all our packages, including locally distilled spirits. Please note we are a fully licensed venue and BYO is not permitted anywhere on the property.

The Station Selection

Our Station Selection is available for 2hrs (\$29pp), 3hrs (\$39pp), 4hrs (\$49) or 5hrs (\$59) duration and includes a choice of three wines and two beers from the following:

Bunnamagoo Mount Lawson (Mudgee)

- Cuvee
- Semillon Sauvignon Blanc or Chardonnay
- Merlot, Shiraz or Cabernet Sauvignon

Selection of Australian Beers

- Great Northern Lager / XXXX
- Coopers Pale Ale
- Byron Bay Premium Lager

Beverage Upgrades

Please enquire for upgrade options to our Cocky's Choice and Homestead Cellar ranges.



Sleeping @ Callubri Station

For those hosting an event at our station we have a range of onsite accommodation packages, and for larger groups charter bus services can be arranged to/from accommodation in Nyngan (35mins).

We have two packages to choose from; the choice is yours;

Freedom (B&B Package) in addition to your luxurious accommodation includes:

- High end commercial linen and towels
- Complimentary boutique body and hair products by Dindi
- A breakfast basket to graze on in the luxury of your accommodation
- Locally made silk purse teas, French press coffee and milk.
- Bathing in our 12-metre mineral lap pool with swim jet and lounges (Sky Suite bookings only).

Escape (Dinner B&B Package) includes all the above plus a few extras:

- A grazing board or BBQ/salad dinner pack to enjoy al fresco at your suite each night.
- A bottle of premium local wine or a few local beers to enjoy with dinner each night.

The above packages are available for our Sky Suites, River Suite, Shearer's Cottage and our new 2-bedroom suite (due for completion mid-2023). In addition to the selection of beverages in your suite we also have a cellar stocked with some of the best drops from our corner of the bush.

Package Rates

Accommodation	Occupancy	Package	Price per night (First night)	Price per night (Subsequent nights)
Shearer's Cottage	6 guests 3 x queen	Freedom	\$325 - 1 bed \$595 - 2 bed \$795 - 3 bed	\$275 - 1 bed \$550 - 2 bed \$750 - 3 bed
		Escape	\$395 - 1 bed \$750 - 2 bed \$995 - 3 bed	\$350 - 1 bed \$695 - 2 bed \$950 - 3 bed
River Suite	2 guests king	Escape	\$495	\$395
Sky Suites	8 guests King/twin	Escape	\$2395	\$1995



The Sky Suites

The Sky Suites are located on the western side of the woolshed and offer four ensuite king rooms with outdoor decks overlooking a twelve-metre mineral container pool with swim jet and sun lounges.

For the ultimate night's sleep, the Sky Suites provide guests with premium pillow top beds with cotton blend linen, feather doonas and a selection of pillows. Large, double-glazed windows surround the bed zone with roller block out/sheer blinds and private views across the property. The ensuites include a walk-in shower, heated towel rail, toilet, timber vanity with mirror, hair dryer and hand-crafted amenities by Dindi.

To ensure guests comfort across the seasons each room features reverse cycle air conditioning/heating and electric blankets in the cooler months, open wardrobe including hanging space, iron and board, bar fridge, microwave, kettle, toaster, cutlery, crockery, and glassware.

Also included in each room is a Bluetooth speaker, premium waffle robes and pool towels.

Please note our suites are not suitable for children under 12 years due to the maximum room occupancy of two guests.



Suite 1 – The Sunrise Suite
(Top Level East Facing)

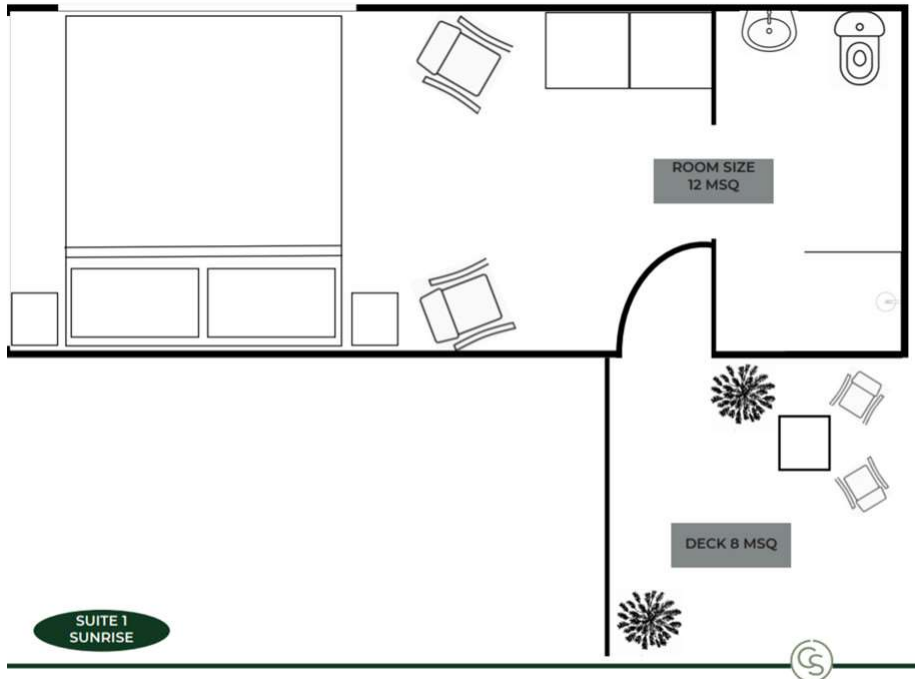



Suite 2 – The Sunset Suite
(Top Level West Facing)

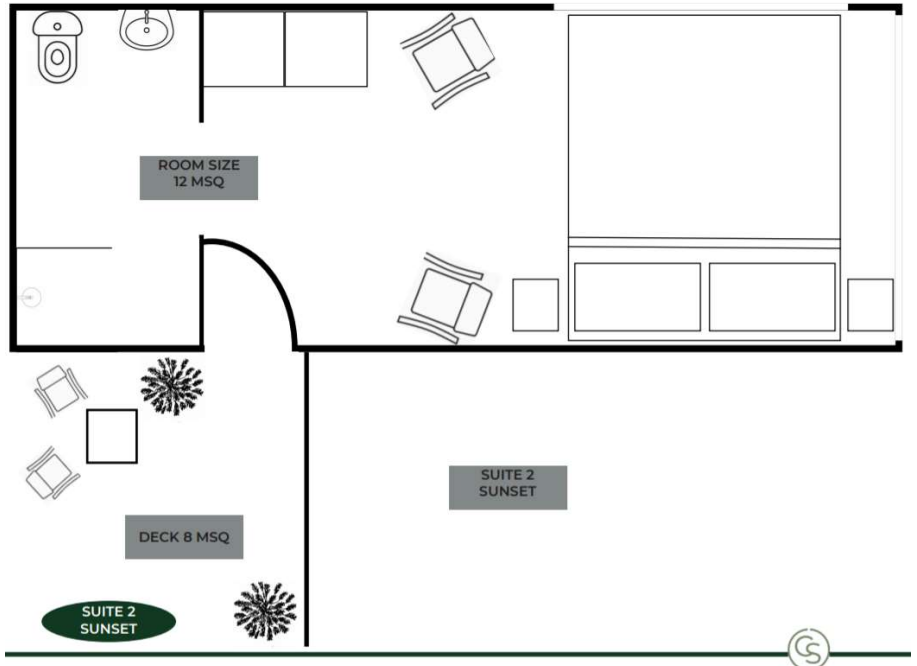



Suite 3 – The Woolshed Suite
(Middle Level East Facing)

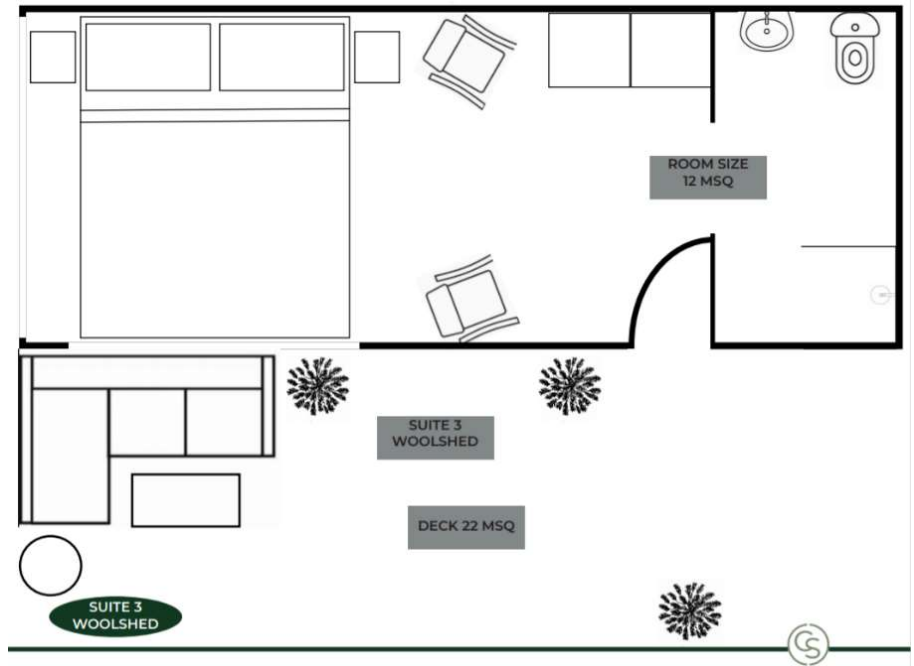



Suite 4 – The Plains Suite
(Middle Level West Facing)

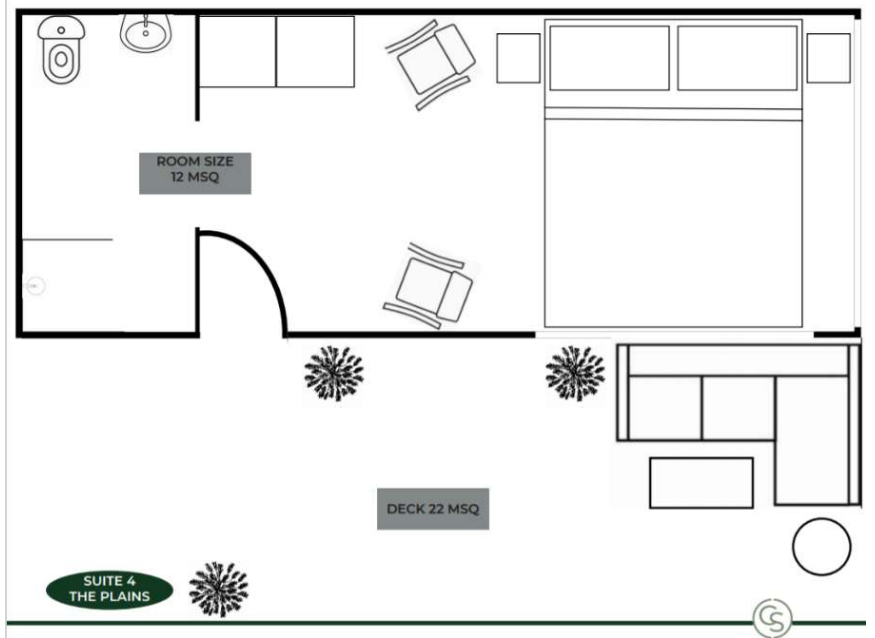

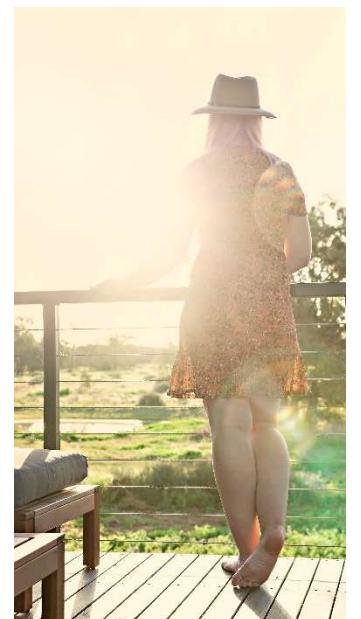
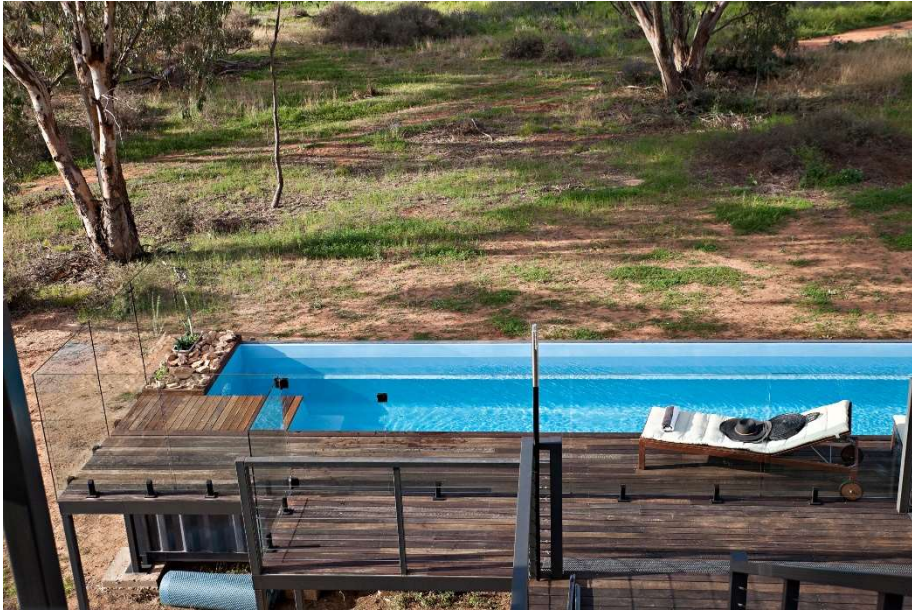



The River Suite

Our River Suite is located separately from the Sky Suites, close to the Shearer's Quarters Guest Lounge and provides accommodation with a ramp and accessible ensuite. The River Suites provides guests with a luxurious pillow top bed with cotton blend linen, feather doona and a selection of pillows to choose from! Large, double-glazed windows surround the bed zone with block out/sheer blinds and private views across the property. The fully accessible ensuite includes a walk-in shower with seat, towel rail, toilet, vanity with mirror, hair dryer and hand-crafted amenities by Dindi.

To ensure guests comfort across the seasons each room features reverse cycle air conditioning/heating and electric blankets in the cooler months, open wardrobe including hanging space, iron and board, bar fridge, microwave, kettle, toaster, cutlery, crockery, and glassware. Also included in each room is a Bluetooth speaker, premium waffle robes and pool towels.

Our suites are not suitable for children under 12 years due to the maximum room occupancy of two guests. Please note that due to our proximity to the river all units are elevated so the accessible ramp is approximately 45m in length.

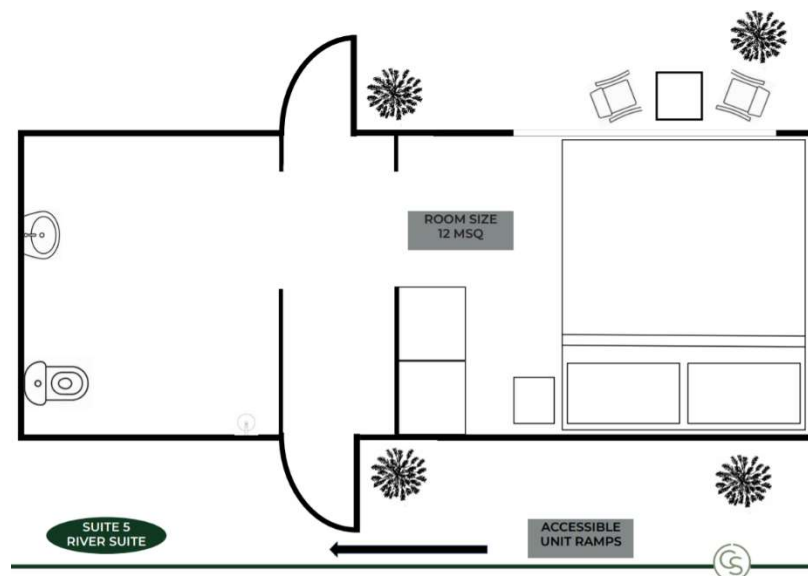





Self-Guided Experiences

Bushwalking, Mountain Biking or Jogging Tracks

The team here are kept busy with the slasher and grader out regularly to keep our tracks clear for guests. With over 28500 acres to explore there is no shortage of adventures. Just ask for a map before you depart and be sure to pack sunscreen, a hat and lots of water!

Fishing and Yabbying

The Bogan River is teeming with underwater activity and despite a high population of carp you may be lucky enough to catch a Yellow-Belly (aka Golden Perch) for dinner! Cast your line from the banks of the Bogan or from one of our lovely row boats! We also have some great reliable dams for yabbying so just ask if you'd like some nets and bait. They pair perfectly with a little butter, some home-grown lemon myrtle and a local chardy!

The Sunset Lookout

Grab a mud map, some beers and bubbles and jump in your car for a short drive across the paddocks to see the best view across the property at golden hour!

Photography

We are happy to host photography workshops but also encourage our visitors to bring their cameras and catch their own personal forever moments.

Moon and Star Gazing

One of the most unique things about living in outback NSW is the number cloudless days and starry nights. When it is a full moon you can see the detail of the craters with your naked eye, binoculars or your camera. The greatest advantage of moon and star gazing is the lack of light pollution caused by city or even and town lights. There is no light pollution interference for visitors because the nearest city is 55 kilometers away.

Native Flora and Fauna

Kangaroos and Wallabies - We have Western Grey, Red Kangaroos and occasionally Wallaroos which are a darker, shorter wallaby.

Bird Life – Callubri Station is home to plethora of outback bird species and a wonderful place for twitchers and casual bird watchers alike. Please just ask if you would like to borrow any books on our local birds or a pair of binoculars. The station is home to large flocks of Pink and Grey Galahs, Twelve Apostles or Lousy Jacks, Top Notch Pigeons, White Corellas, Mallee Ring Necked Parrots, Magpies, Peewees, Honey Eaters, Finches, Native Doves, Pelicans, Black Swans, Water/Swamp Hens, Ibis, Kingfishers, Butcher Birds, Kookaburras, Herron, Bittern, Bowerbird, Blackbird, Crows and Ravens, Mud Swallows, Hopping Bobs (Bablers), Fairy Martins, Eastern Rosellas, Blue Bonnets, Black Cockatoos, Wood Ducks, Divers, Larks, and many more. In early spring you may even spy a flock of baby emus running behind mum! If you look up high, we are constantly being observed by Sparrow Hawks, Brown and Black Kites and even the king of the raptors, The Wedge Tail Eagle gliding high overhead on thermals.

Reptiles - We have many scaly friends (and some we would prefer not to make friends with!) here in Outback NSW. We mainly see Carpet (Pythons) and Western Brown, Red Bellied Black, Green Tree and Whip Snakes, Goannas, Frill-less Frill Neck Lizards, Geckos, Blue Tongue Lizards and Shinglebacks.

Amphibians – Our river area is home to Green Tree Frogs and Cardinal Frogs.

Vegetation - Callubri Station is in a region that generally receives less than 400mm a year. Most of the vegetation is xerophytic meaning that it is drought tolerant and includes Wilgas, Eucalypts, Red/Yellow/White/Black Box, Kurrajongs, White Cypress Pines, Warrior Bush, Sandlewood, Budda, Wattles, Belah, River Cooba, Myall, Quandong, Rosewood, Whitewood, Leopard Wood, Fuscia Bush, Yarran and many more.

Seasonal Bush Flowers - Daisies, Billy Buttons, Sturts Desert Pea, Wild Turnip, Wattles and Gums.

Creek Beds and Springs - We have two creeks; Bloochers Cowal and Mulla Cowal that head across our swamp paddock and Euloglen house block. The creeks are ephemeral as they only run if we receive over 2 inches of rain.

Identification Books and Binoculars - We have several books and binoculars that we allow our guests to borrow. Please ask at the guest lounge.



Signature Experiences

Farm Tours - Subject to Availability - 3hr duration - \$595 up to four guests, \$895 up to eight guests

'Smoko' and Farm Exploration - Before we head bush, wander up to the Shearer's Quarters to grab a fresh brew! After 'smoko' jump aboard as we fire up the old Landcruiser and take to the dirt tracks to show you our beautiful corner of the world. Today's trip will start with a wander through the old hand chiseled timbers of our original "Callubri Station" woolshed built in the late 1800s before heading through the livestock paddocks and culminating in a tour of our new shearing shed at Euloglen halfway across the property.

Farm Adventure and The Lookout Sundowners - Time to get your bearings across our 28,000-acre station! Today's adventure will take in our cropping fields, the large machinery we use to sow and harvest the crops and culminate with sundowners on 'The Lookout'. Cast your eyes over hundreds of kilometers of the wild Western Plains at our most popular spot for sunset, enjoy a refreshing beverage and farewell another perfect outback day.

Staying Longer?

Are you keen to see the day-to-day activities of the farm? Whether it be moving a mob of sheep or assisting with crop inspection there is always something to get involved with! Please refer to our farm calendar for seasonal activities.



Bespoke Experiences

Pioneers' Picnic - \$195 per couple

Wine and dine your loved one on a sumptuous spread of handmade goodies prepared with the love and care of a bygone era. A short wander will bring you to a secluded location for a private dining experience like no other. Nestle down in the vintage rugs and cushions, pop a vinyl on and settle in to feast on delicate finger sandwiches, freshly baked pastries, specialty tea and of course a bottle of the divine vintage Swift cuvee, made using time honored French traditions.

Boating and Bubbles - \$195 per couple

Indulge in the chance to romantically row your loved one around our river lagoon in a vintage timber rowboat dining on a gourmet spread of local produce. Enjoy a selection of locally produced cheeses, cured meats, house made pickles, dips and crudités, fresh fruit, and a bottle of the divine vintage Swift cuvee.

Moon Bathing - \$195 per couple

Fancy something a little special to treat your main squeeze or bestie? After a short meander along the river, in the distance you notice a secluded spot on the river bend with a quirky, vintage farm ute of a different kind! A closer peak reveals two side by side vintage clawfoot bathtubs perched on the tray alongside a rustic enamel sink filled with ice and the highly awarded Swift Vintage Cuvee. A selection of artisan spa products from our friends at Dindi Naturals are on offer for your soak and pure cotton waffle robes and slippers to keep you cosy. Adorning the hand-crafted grazing board is a spread of local gourmet goodies to graze on as the sun goes down. Oh and some soothing vinyls playing from the portable gramophone. Sound like heaven? We think so!



Our Environment

Our farm is in the heart of the Western Plains and is classified as a semi-arid zone. We generally don't experience either summer or winter dominant rainfall however as you can see it can get pretty toasty during the summer months. Please note the below temperatures indicate our averages and temperatures can reach up to 45 degrees in summer and down to 0 degrees in winter!

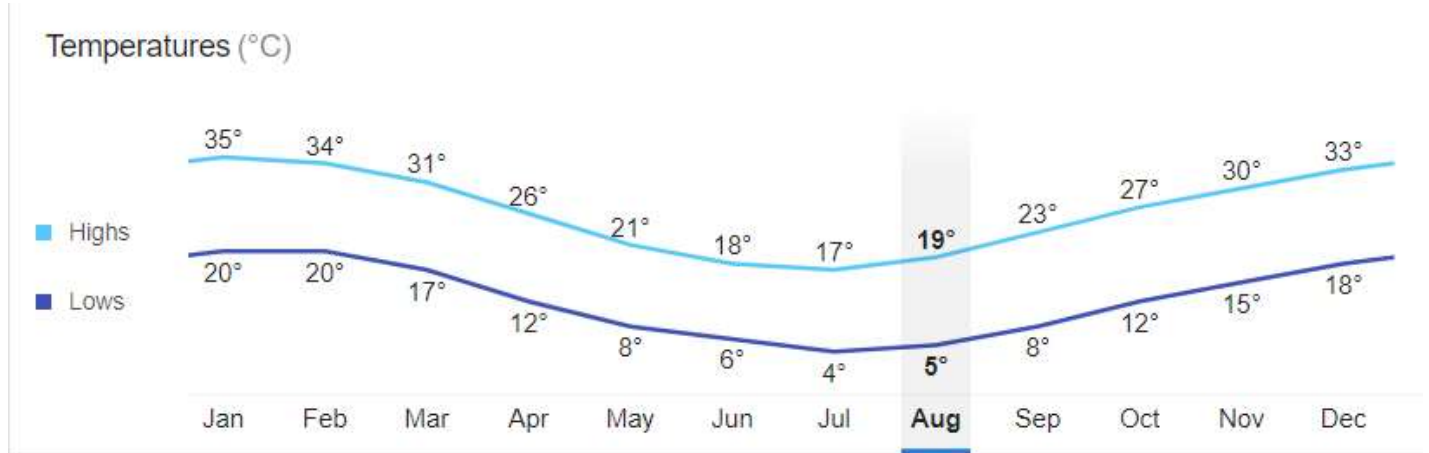

The Farm Calendar

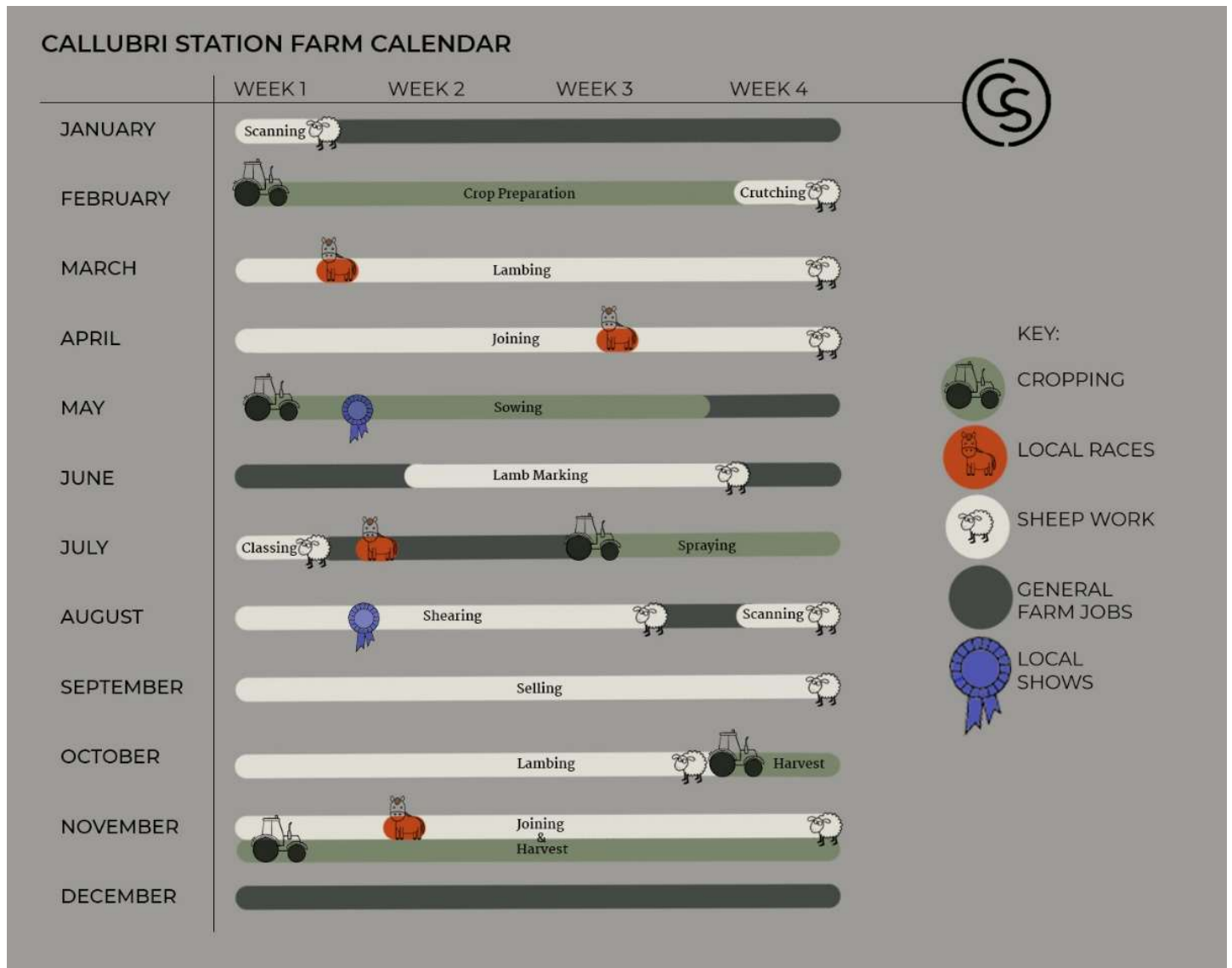

Our Location

Our station is located 52kms South of Nyngan (pop 3500), 48kms North of Tottenham (pop 300) and 53kms West of Nevertire (pop 225) in the Central West Plains of NSW. Our closest regional centre is Dubbo (160kms).

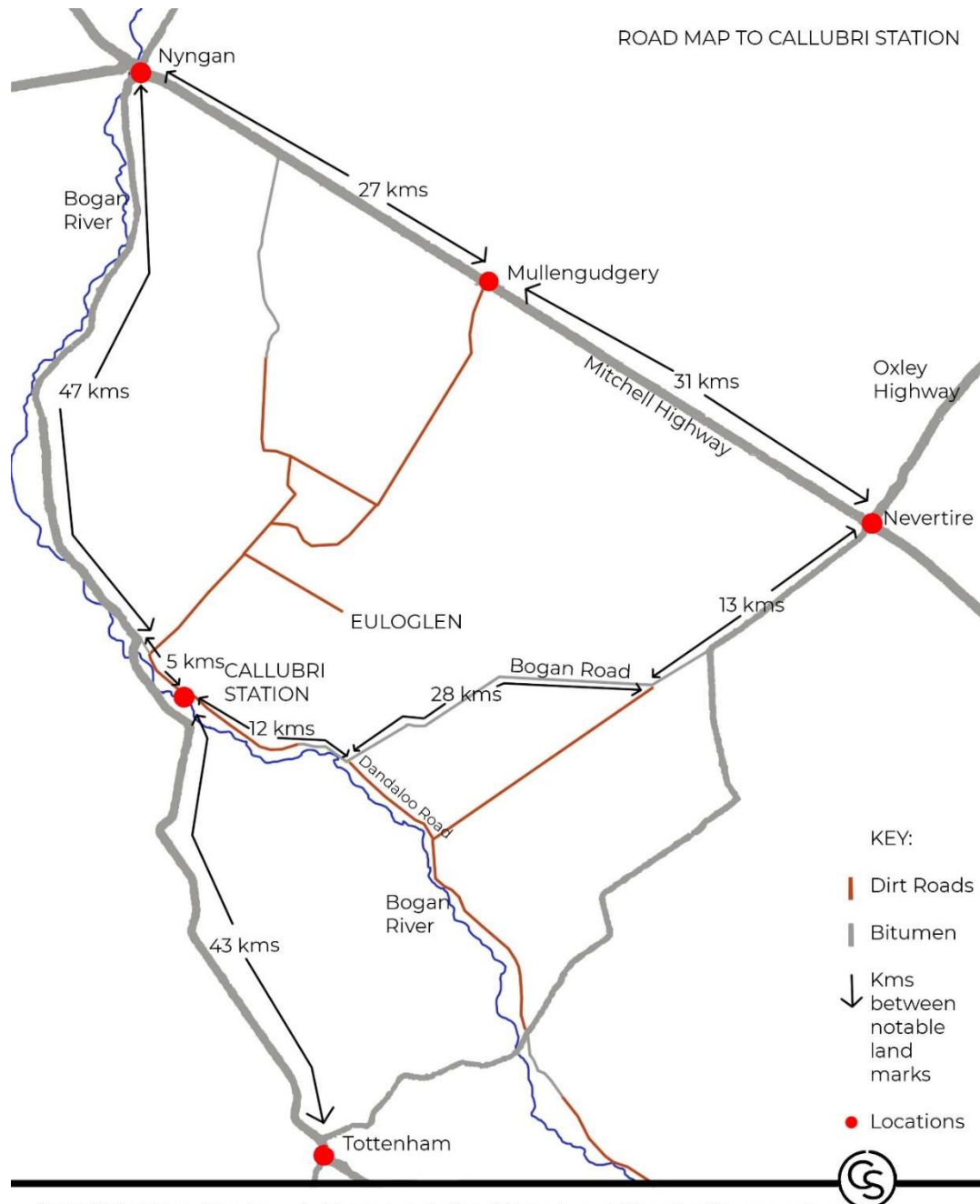

From Tottenham drive towards Nyngan and after 43 kms turn right at the big green sign to Mullengudgerly, Nevertire and Dandaloo. Drive 5kms (1km sealed, 4kms dirt) and turn right at our main gate with the Callubri Station sign.

From Nevertire drive towards Tottenham and after 13 kms turn right onto Bogan Rd. Travel 28kms to the end of the road and turn right at the T intersection. Drive 12kms (3km sealed, 9kms dirt) and turn left at our main gate with the Callubri Station sign.

From Nyngan drive towards Tottenham and after 47 kms turn left at the big green sign to Mullengudgerly, Nevertire and Dandaloo. Drive 5kms (1km sealed, 4kms dirt) and turn right at our main gate with the Callubri Station sign.



Angie and Mike Armstrong
Callubri Station
ABN 17 621 305 039

+61 403 571 331 / +612 6847 3839
info@callubristation.com.au

Callubri Station, 586 Dandaloo Rd,
Buddabadah, NSW, 2825
www.callubristation.com.au

Available Dates

Bookings may be made year-round subject to availability. We ask that guests are made aware of potentially high temperatures and the adjustments that may be made to ensure guest comfort during the summer months from November to February.

Venue Hire

The following venue hire fees apply (in addition to your chosen package) to ensure the venue is clean and set to your seating preference:

- **\$250** The Shearer's Quarters Hall (120 Seated, 200 cocktail)
- **\$125** The Shearer's Quarters Outdoor Bar and Dance Deck (open air, 60 seated, 120 cocktail)
- **\$100** The Shearer's Quarters Lounge Deck (covered, 24 seated, 30 cocktail)
- **\$550** The Woolshed (120 cocktail)
- **\$750** The Woolshed (120 cocktail capacity with church pew seating for 80 for ceremonies)

Please note all items belonging to the client must be removed from the venue by 11am of the morning following the event. Please note the function durations for all packages. Additional fees may apply if your function exceeds the duration.

Food Allergies and Dietary Requirements

We have a wide range of canapes, entrees, mains and desserts to suit all events. We are also happy to customise a menu to suit your specific requirements & personal style. Please select your menu and advise of any dietary requirements and seating of guests four weeks prior to your event. All menus are a guide and may vary with seasonal produce and availability. We are more than happy to cater for guests with allergens however as we are a small kitchen operation we do not cater for trending dietary requirements and allergens may be present.

Beverages

Our venue is fully licensed and we stock a wide range of local wines, beers & a wide selection of spirits. Under licensing laws, no beverages (alcoholic) are permitted to be brought onto the grounds and all beverages are to be purchased from The Cocky's Wife Catering and Events. Please note that as a licensed facility we are governed by and strictly adhere to Responsible Service of Alcohol (RSA). The

Cocky's Wife Catering and Events reserves the right to refuse service to or ask guests to leave the premises should this action be deemed necessary. Bar service will close strictly 30 minutes prior to the end of the event.

Access and Set Up

We cannot guarantee availability for set up the day before your event. If the venue is available the day prior to your event, you are welcome to come and set your table and room decorations at a time pre-arranged with the Functions Coordinator. If the venue isn't available a day prior to your event, you will need to arrange to set the room up on the morning of your event. Available staff will also assist with the setting up. If you're hiring a decorator, please ensure that you check venue availability with the Functions Coordinator prior to arranging a set up time.

Audio and Visual

The following AV equipment can be supplied and set up at no additional costings. Please advise us of your requirements: Data projector & screen, microphones, interior & exterior sound system with most phone connections (please check that your device is compatible prior to event). Please note that The Cocky's Wife Catering and Events and Callubri Station does not have an IT employee on site therefore we are unable to provide any technical support before or during your event. If your event is of particular importance, we encourage you to use a professional AV company to supply and set up equipment as required and provide support during your event.

Payment Policy

A deposit of 20% is payable within 14 working days of making your booking to hold the date for your event. This deposit will be credited to the final balance. By paying the deposit you are accepting and agreeing to all the terms and conditions outlined in this package. Callubri Station and The Cocky's Wife Catering and Events reserves all rights to cancel a tentative booking where no deposit has been received. Full payment will be invoiced and due four weeks prior. Please confirm final numbers, menu, dietary requirements, run sheet and room lists 28 days prior.

Damages

Damages are the responsibility of the organizer, Callubri Station and The Cocky's Wife accept no responsibility for damaged or lost property. Organisers are responsible for any damage that is sustained to the function area, grounds or accommodation sites prior to, during and after the event.

Booking Policy

As a boutique farm stay property, our business depends on maximising occupancy and cancellations often result in empty rooms due to booking lead times.

No refunds can or will be given in connection with circumstances arising beyond the reasonable control of Callubri Station eg. flight delays or guest failure to appear for accommodation. No refund can be given for any unused services or early departures. We strongly urge comprehensive travel insurance to cover clients for cancellations, medical emergencies, additional expenses etc.

Any cancellations made 61 days or more prior to arrival; no cancellation fees apply.

Any cancellations made 60 – 31 days prior to arrival; a 25% cancellation fee applies.

Any cancellations made 30 – 15 days prior to arrival; 50% cancellation fee applies.

Any cancellations made 14 – 0 days prior to arrival; 75% cancellation fee applies.

No refund will be given for any unused services or early departures.

Please note we are located on a gravel road and may not be passable to some vehicles after significant rainfalls. We are happy to offer a pickup service under these circumstances and will advise a secure location to leave your vehicle accordingly.

In the rare event that the road is cut by floodwaters we will provide a minimum 5 days' notice and will endeavour to assist with suitable alternate accommodation options. A full refund will be provided.

Public Holiday Surcharge

Please note a surcharge of 20% will apply for bookings made on all NSW public holidays.

We look forward to welcoming you to our home.



Callubri

STATION

Angie & Mike Armstrong

The Cocky's Wife @ Callubri Station

+612 6847 3839

+61 403 571 331

info@callubristation.com.au

"Callubri Station"
586 Dandaloo Rd
Buddabadah, NSW, 2825

www.callubristation.com.au
www.facebook.com/callubristation
www.instagram.com/callubristation